

Soils Map

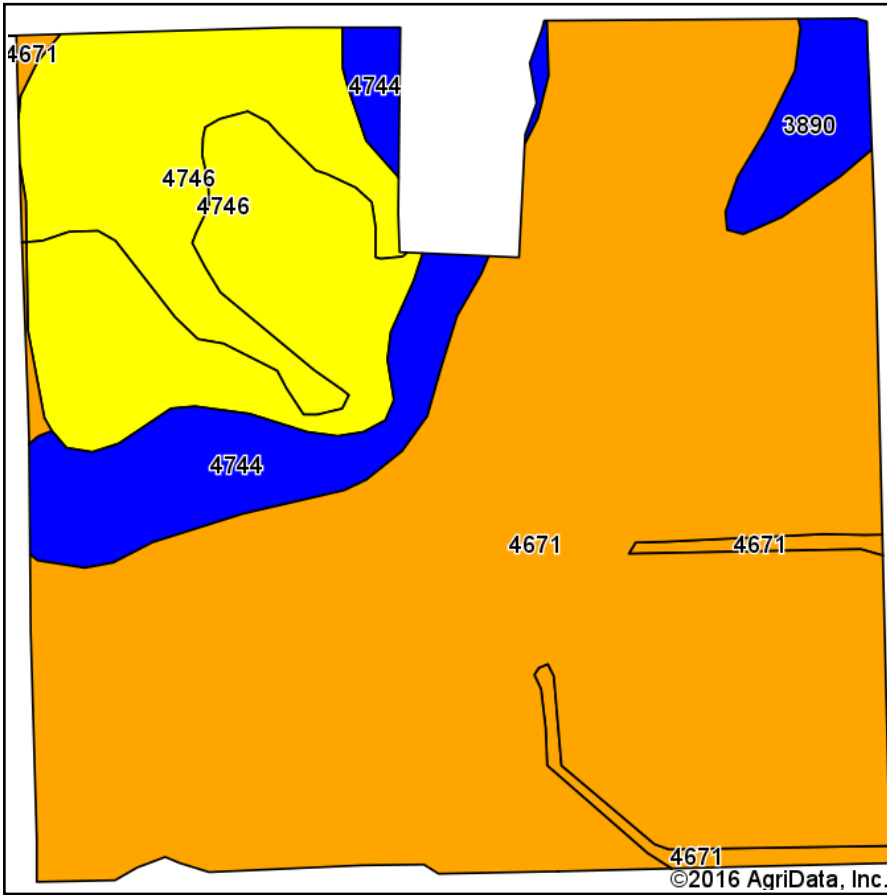

Soils data provided by USDA and NRCS.

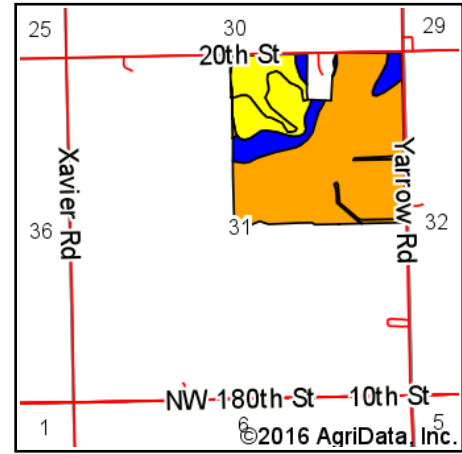

State: **Kansas**
 County: **Marion**
 Location: **31-22S-5E**
 Township: **Milton**
 Acres: **150.98**
 Date: **4/15/2016**

Maps Provided By:



© AgriData, Inc. 2016

www.AgriDataInc.com



Area Symbol: KS115, Soil Area Version: 12

Code	Soil Description	Acres	Percent of field	Non-Irr Class Legend	Non-Irr Class *c	Irr Class *c
4671	Irwin silty clay loam, 1 to 3 percent slopes	104.84	69.4%		III _s	III _s
4746	Labette-Sogn silty clay loam, 0 to 8 percent slopes	30.71	20.3%		IV _e	III _e
4744	Labette-Dwight complex, 0 to 3 percent slopes	11.51	7.6%		II _e	II _e
3890	Ladysmith silty clay loam, 0 to 1 percent slopes	3.92	2.6%		II _s	II _s

Area Symbol: KS115, Soil Area Version: 12

*c: Using Capabilities Class Dominant Condition Aggregation Method

Soils data provided by USDA and NRCS.