

Aerial Map



©2018 AgriData, Inc.

map center: 38° 15' 14.74, -97° 10' 46.54



Maps Provided By:

CUSTOMIZED ONLINE MAPPING
© AgriData, Inc. 2018 www.AgriDataInc.com

2-21S-2E
Marion County
Kansas

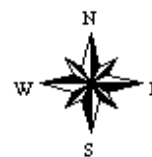

1/31/2018

Aerial Map



©2018 AgriData, Inc.

map center: 38° 15' 3.41, -97° 11' 3.14

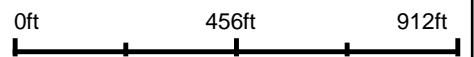

Maps Provided By:

CUSTOMIZED ONLINE MAPPING
© AgriData, Inc. 2018 www.AgriDataInc.com

2-21S-2E
Marion County
Kansas

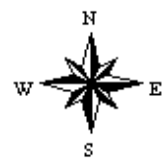

1/31/2018

Topography Map

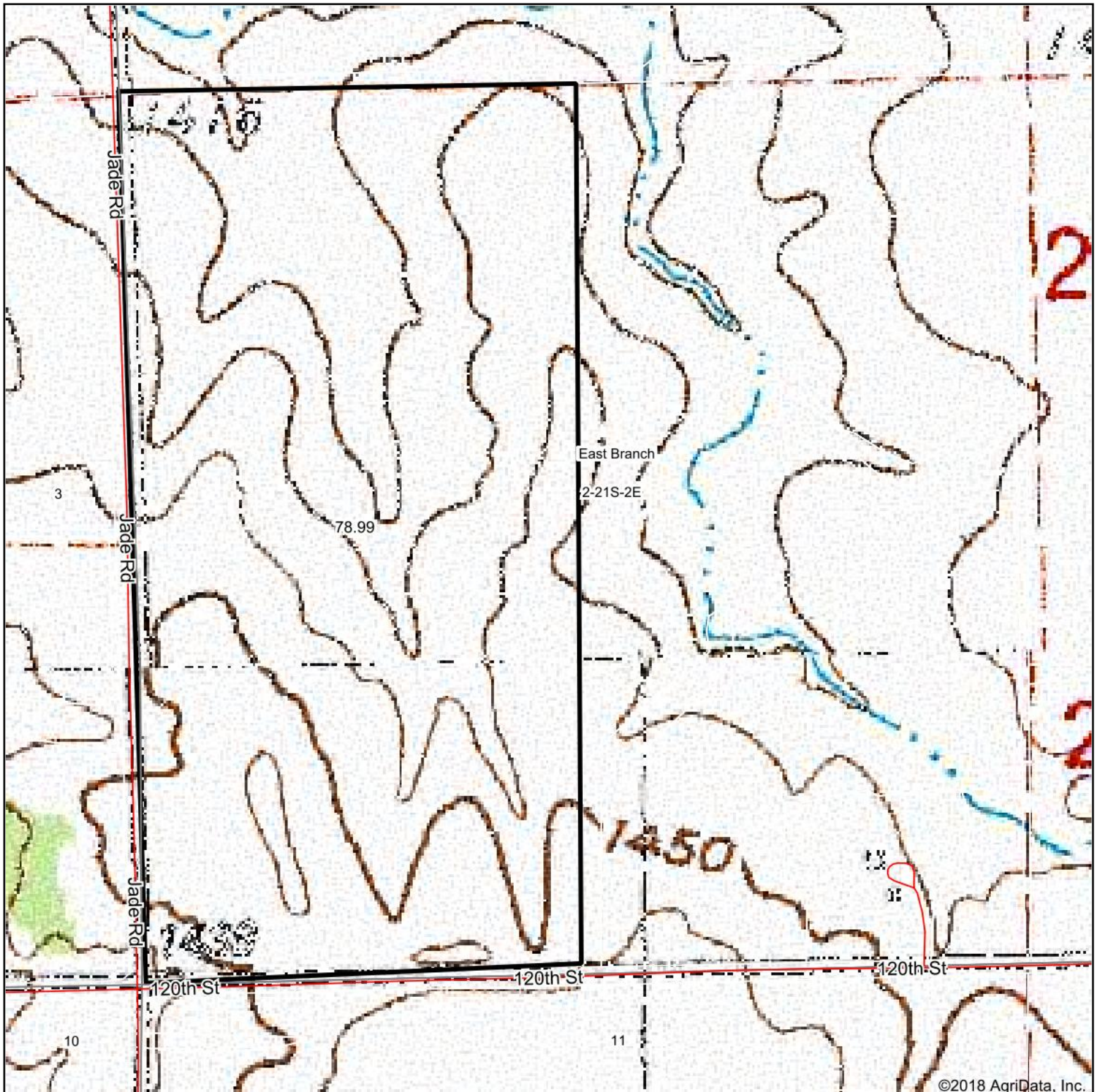

©2018 AgriData, Inc.

map center: 38° 15' 3.41, -97° 11' 3.14

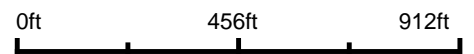

2-21S-2E
Marion County
Kansas

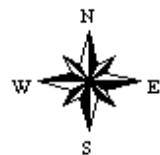

1/31/2018

Maps Provided By:



© AgriData, Inc. 2018

www.AgriDataInc.com

Soils Map

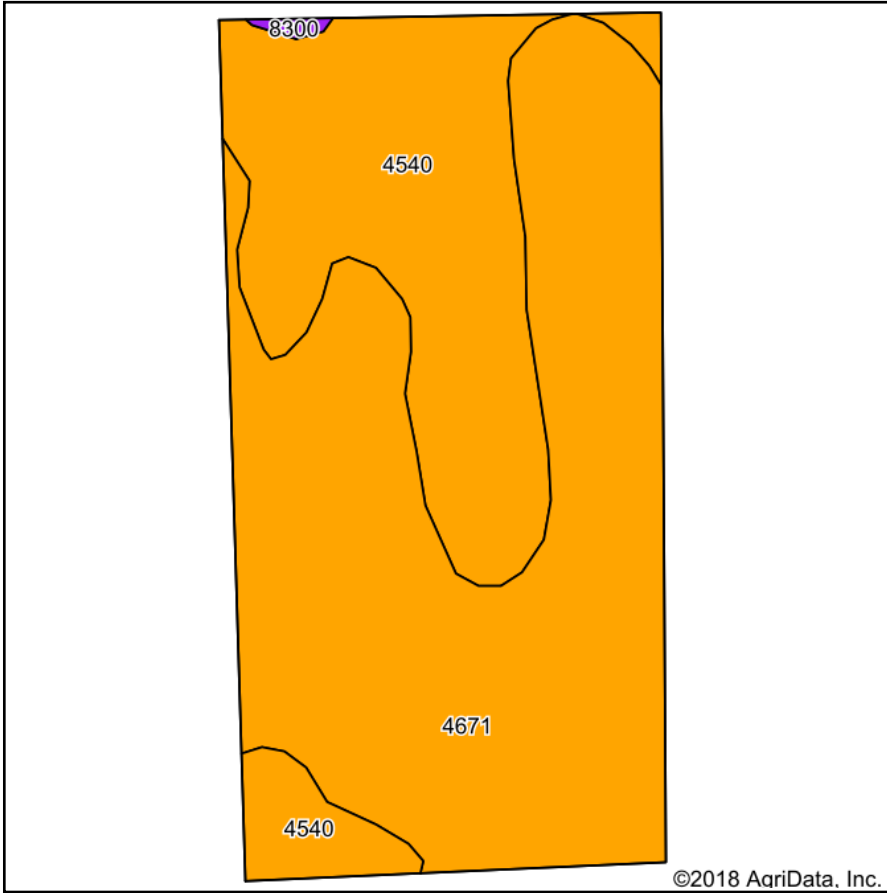

Soils data provided by USDA and NRCS.

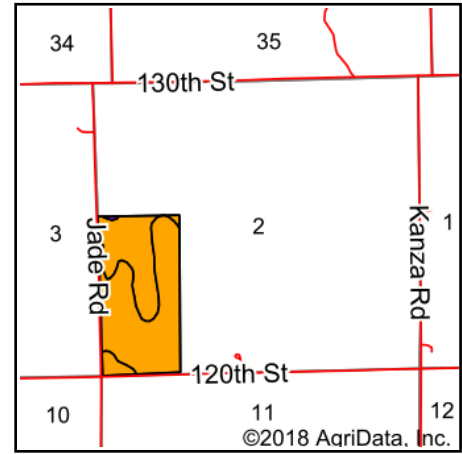

State: **Kansas**
 County: **Marion**
 Location: **2-21S-2E**
 Township: **East Branch**
 Acres: **78.99**
 Date: **1/31/2018**

Maps Provided By:



Area Symbol: KS115, Soil Area Version: 14

Code	Soil Description	Acres	Percent of field	Non-Irr Class Legend	Non-Irr Class *c	Irr Class *c
4671	Inwin silty clay loam, 1 to 3 percent slopes	50.70	64.2%		IIIs	IIIs
4540	Clime silty clay loam, 1 to 3 percent slopes	28.05	35.5%		IIIe	IIIe
8300	Verdigris silt loam, channeled, 0 to 2 percent slopes, frequently flooded	0.24	0.3%		Vw	

*c: Using Capabilities Class Dominant Condition Aggregation Method

Soils data provided by USDA and NRCS.